

RIV 161

Double-acting pneumatic jack in brass
with PPS system and position sensors
Perla / Diamante / Centurion / Vulcano series

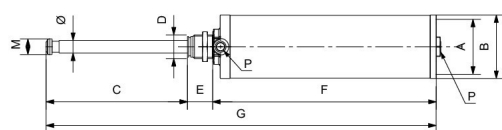

Tech drawings and tables



DN	Code	Ø	F	B	C	D	E	G	M	P	KG	P/box
4"	050161000016	16	233	81	124	M30x2	32	389	20	1/4"	4,290	1
5"	050161000018	16	264	81	155	M30x2	32	451	20	1/4"	4,975	1
6"	050161000019	16	289	81	180	M30x2	32	501	20	1/4"	5,223	1
8"	050161000020	16	330	81	238	M35x2	32	599	23	1/4"	5,552	1

Advantages

Completely made in brass, to avoid the oxidation and to guarantee a long product life.

The exclusive "PPS" (Power Plus System) patented by RIV gives the advantage of controlling automatically the power while closing, by differentiating it from the one needed during the opening.

During the closing cycle, thanks to a special double chamber system, it is always possible to use the optimal power, avoiding in this way any possible damage to the gate valve seats.

On the contrary, during the starting phase of the opening cycle, this system doubles the power needed.

This type of jacks guarantees a longer and better working life of the RIV gate valves, the saving of the cost of a pressure reducer and the following adjustment operation needed with the traditional jacks.

The "PPS" is another RIV patent.

Technical data

Limit	-10°C +80°C
Notes	MINIMUM OPERATING PRESSURE: 4", 5", 6" = 5 Bar (75 Psi) 8" = 6 Bar (90 Psi)
	MAXIMUM OPERATING PRESSURE: 12 Bar (175 Psi)